

Dimensiones
Dimensions
Massgängen
Dimensions
Dimensioni
Medidas

	C mm	L mm	A mm	kg
Z-100-7	7	56	49	0,08
Z-100-10	10	62	52	0,09
Z-100-15	15	72	57	0,09
Z-100-25	25	92	67	0,11
Z-100-38	38	118	80	0,12
Z-100-50	50	142	92	0,13
Z-100-63	63	168	105	0,15
Z-100-63-EI	63	172	109	0,17
Z-100-80	80	205	125	0,18
Z-100-100	100	245	145	0,18
Z-100-125	125	295	170	0,24

Consultar carreras fuera de catálogo / Other strokes can be produced on request

Ejemplo de pedido / Ordering example:

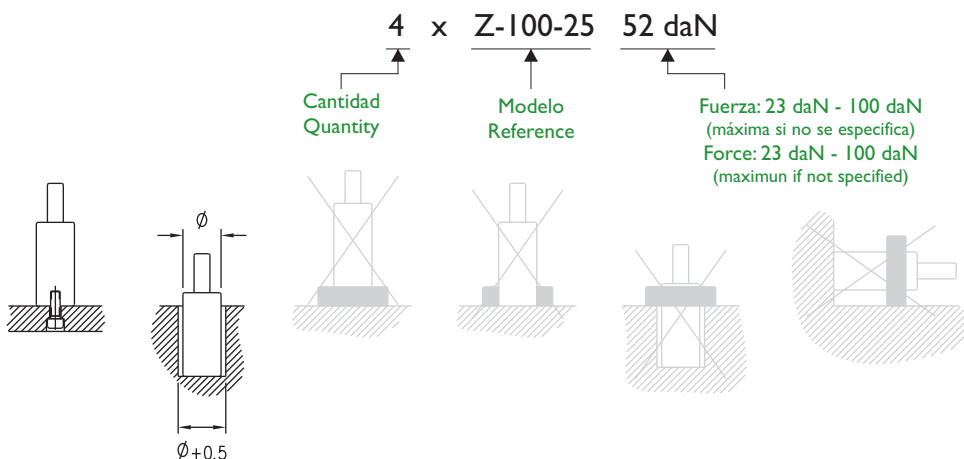

Max. Recomend. 1,6 m/s
20°C / 68°F
30-110 golpes/min / 30-110 strokes/min

12% min

N₂

Max 88bar / 1276psi
Min 20bar / 290psi

Max 80°C / 176°F
Min 0°C / 32°F

> 80°C (176°F) → Kit Viton

+1°C / +1,8°F = +0,34%

Repair Kit
KIT Z-100_I

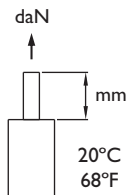
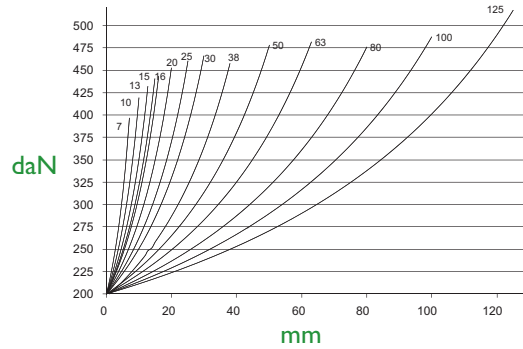
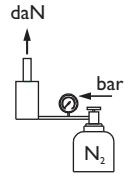
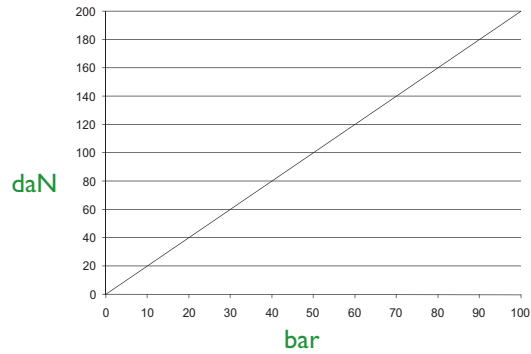
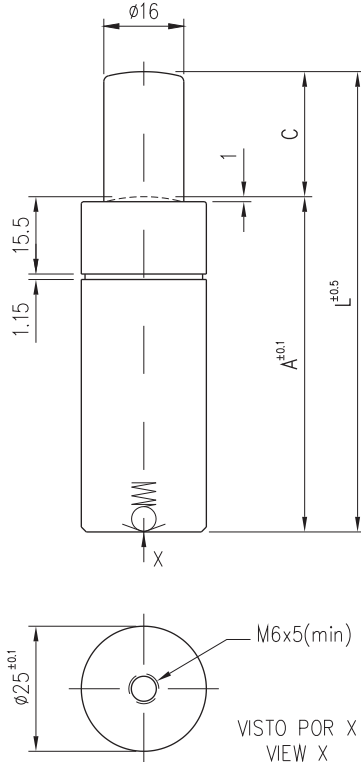

Dimensiones
Dimensions
Massgängen
Dimensions
Dimensioni
Medidas

	C	L	A	
	mm	mm	mm	
Z-200-7	7	56	49	0,15
Z-200-10	10	62	52	0,16
Z-200-13	12,7	67,4	54,7	0,17
Z-200-15	15	72	57	0,17
Z-200-16	16	74	58	0,18
Z-200-20	20	82	62	0,19
Z-200-25	25	92	67	0,20
Z-200-30	30	102	72	0,21
Z-200-38	38	118	80	0,22
Z-200-50	50	142	92	0,24
Z-200-63	63	168	105	0,26
Z-200-80	80	205	125	0,29
Z-200-100	100	245	145	0,33
Z-200-125	125	295	170	0,37

Consultar carreras fuera de catálogo / Other strokes can be produced on request

Ejemplo de pedido / Ordering example:

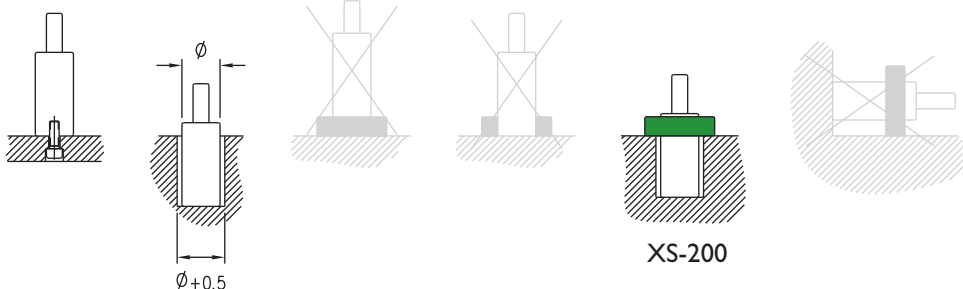
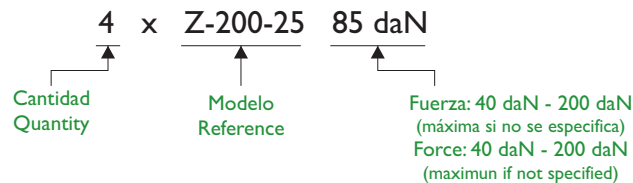

Max. Recomend. 1,6 m/s
30-110 golpes/min
30-110 strokes/min

12% min

N₂

Max 100bar / 1450psi Min 20bar / 290psi

Max 80°C / 176°F Min 0°C / 32°F

> 80°C (176°F) → Kit Viton

+1°C / +1,8°F +0,34%

Repair Kit
KIT Z-200_I